

# EAL Holdings, LLC.

- Request EMP from R-2
- Staff Recommendation:
  - Approval
- Planning Board Recommendation:
  - Approval

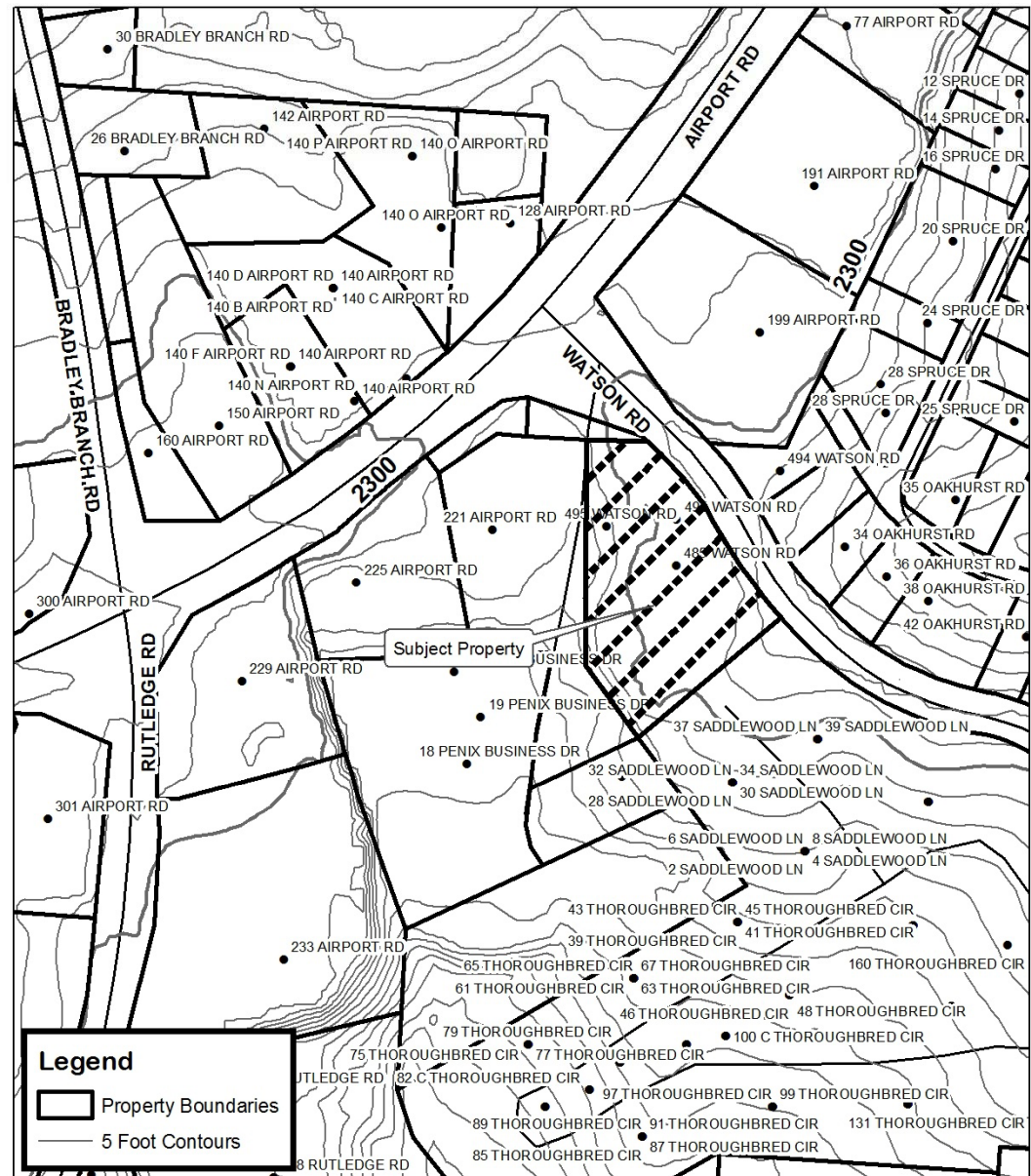

**EAL Holdings, LLC  
Map Amendment**

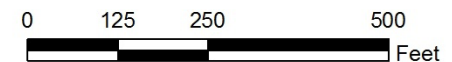

Property Size: 1.68 acres (0.72 acres zoned R-2)  
 Application Date: April 8, 2011  
 Planning Board Hearing Date: May 16, 2011

Created By: Buncombe County Planning  
 Date: March 3, 2011

## EAL Holdings, LLC.

- Request EMP from R-2
- Staff Recommendation:
  - Approval
- Planning Board Recommendation:
  - Approval



**EAL Holdings, LLC  
Map Amendment**



0 300 600 1,200  
Feet

Property Size: 1.68 acres (0.72 acres zoned R-2)  
Application Date: April 8, 2011  
Planning Board Hearing Date: May 16, 2011

Created By: Buncombe County Planning  
Date: May 3, 2011

## EAL Holdings, LLC.

- Request EMP from R-2
- Staff Recommendation:
  - Approval
- Planning Board Recommendation:
  - Approval

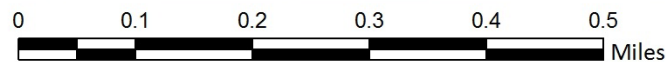
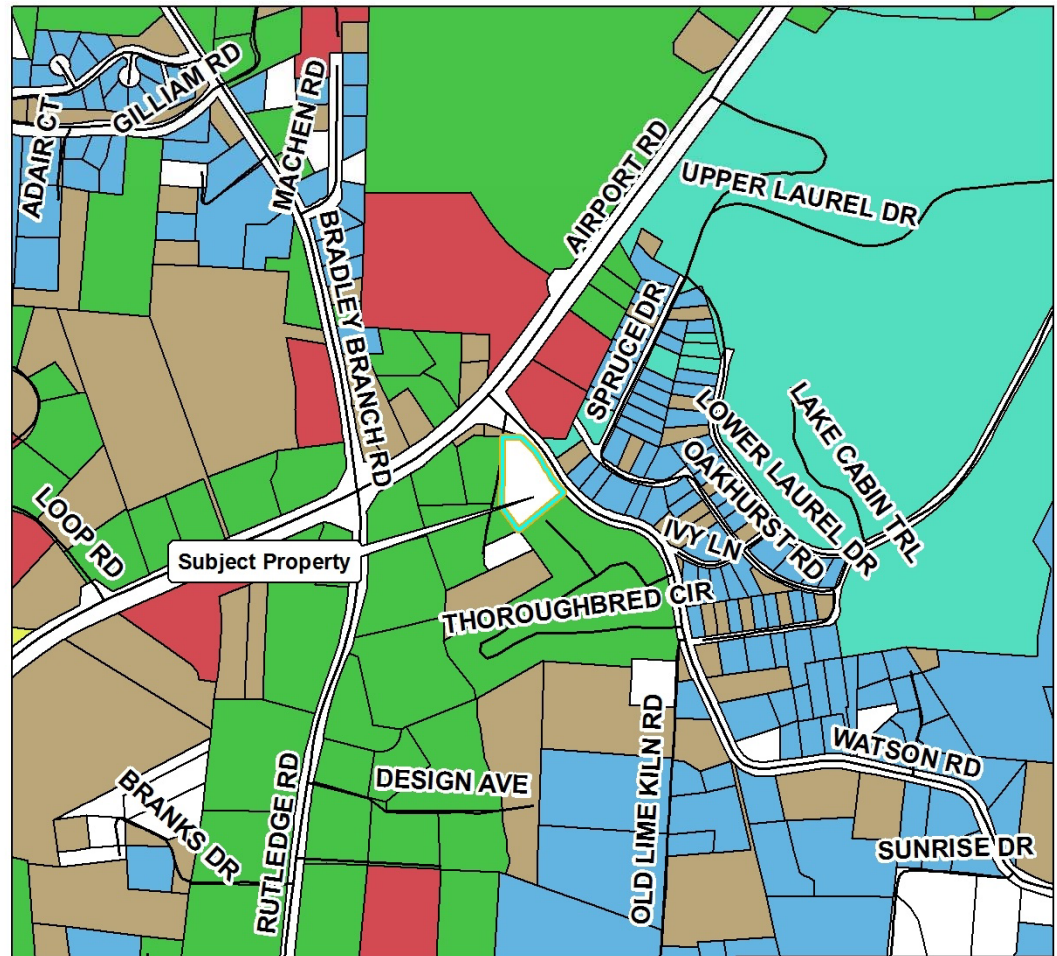

### EAL Holdings, LLC Map Amendment

Property Size: 1.68 acres (0.72 acres zoned R-2)  
Application Date: April 8, 2011  
Planning Board Hearing Date: May 16, 2011

Created By: Buncombe County Planning  
Date: May 3, 2011

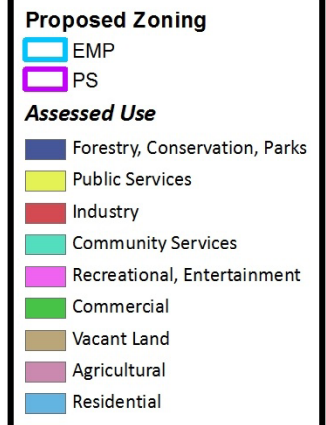

# EAL Holdings, LLC.

- Request EMP from R-2
- Staff Recommendation:
  - Approval
- Planning Board Recommendation:
  - Approval

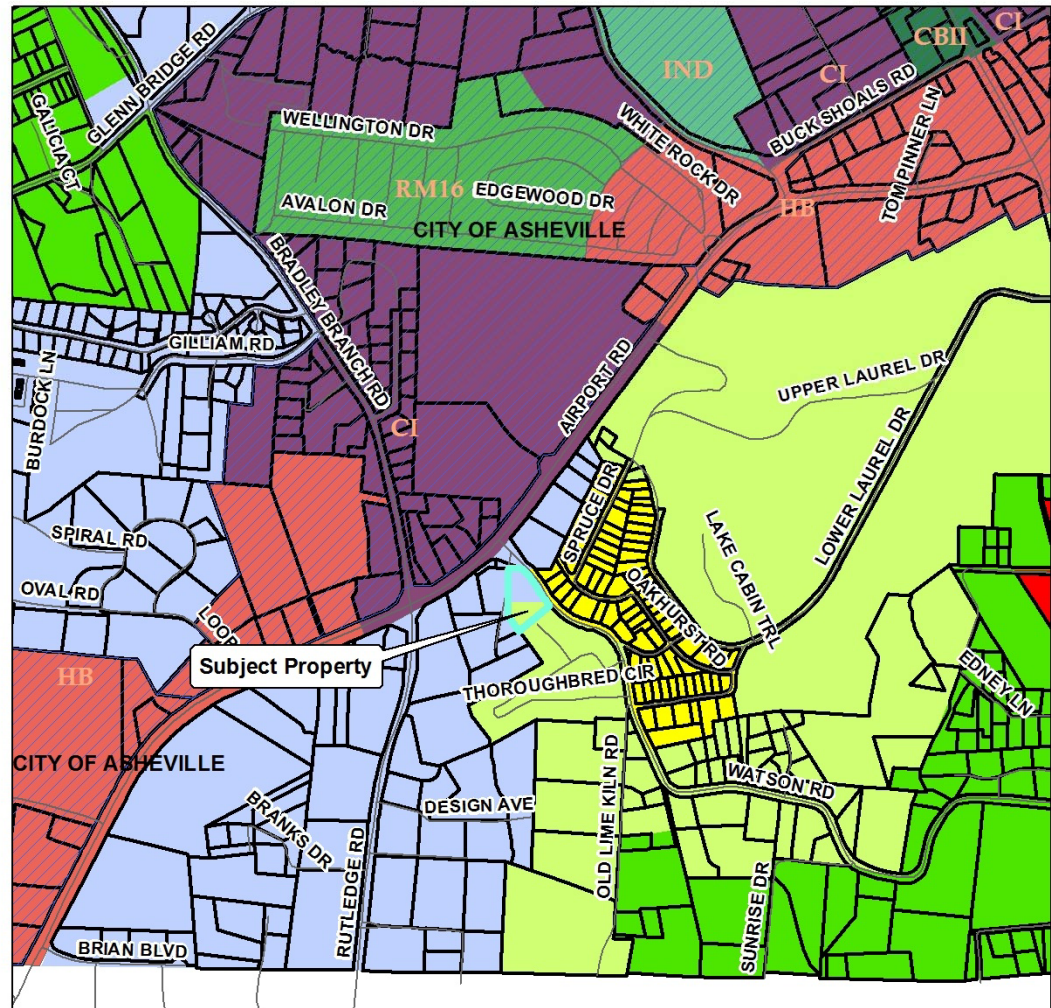

**EAL Holdings, LLC  
Map Amendment**



Zoning Districts		Zoning Overlays	
BDM	R-1	Blue Ridge Parkway Overlay	Protected Ridge & Parkway
CS	R-2	Protected Ridge Overlay	Steep Slope/High Elev.
EMP	R-3	Steep Slope/High Elev. & Pkwy	
NS	R-LD		
OU			

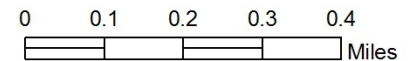

Property Size: 1.68 acres (0.72 acres zoned R-2)  
 Application Date: April 8, 2011  
 Planning Board Hearing Date: May 16, 2011

Created By: Buncombe County Planning  
 Date: May 3, 2011